



TYPE EXAMINATION CERTIFICATE

According to Lifts Regulations 2016, Schedule 11, Section A

Certificate No.:	UK-UCM 007/2
Approved Body:	TUV SUD BABT UNLIMITED Octagon House Concorde Way, Segensworth North Fareham, Hampshire, PO15 5RL, UK Identification No. 0168
Certificate Holder:	Blain Hydraulics GmbH Pfaffenstraße 1 74078 Heilbronn - Germany
Manufacturer of the Test Sample: <small>(Manufacturer of Serial Production - see Enclosure)</small>	Blain Hydraulics GmbH Pfaffenstraße 1 74078 Heilbronn - Germany
Product:	Hydraulic valve for a brake element as part of a protection against unintended downward car movement
Type:	L10 2"
Regulation:	Lifts Regulations 2016
Reference Standards:	EN 81-20:2020 EN 81-50:2020
Test report:	No. UK-UCM-004-1_007-2 dated 2022-10-26
Outcome:	The product conforms to the essential health and safety requirements of the mentioned Regulation if the requirements of the annex to this type examination certificate are kept.
Date of Issue:	2022-11-07

 Achim Janocha
 TUV SUD BABT UNLIMITED



1 Scope of application

Hydraulic valve for a brake element as part of a protection against unintended downward car movement, type L10 2"

Maximum braking distance after triggering up to	800 mm
Maximum permissible distance: level position - triggering up to	250 mm
Permissible nominal speed up to	1.0 m/s
Permissible release speed up to	1.3 m/s
Permissible nominal flow	≤ 800 l/min
Nominal pressure range	12 - 59 bar
Viscosity range	20 - 450 cSt

2 Conditions

- 2.1 For identification and information about the principal design and operation and for demarcation of the examined and approved sample the approval drawing, no. L10-2.0" F KS b dated 2022-07-20 (page 1-2) with certification stamp of 2022-10-06 has to be enclosed to the type examination certificate and its annex.
- 2.2 The above-mentioned safety component represents only one part of the protective equipment against movements of the car in downward direction. Only in combination with a detection and triggering component (also two different components are possible), which must be subjected to an own type-examination according to the test procedure specified in EN 81-50:2020, section 5.8, the created system can fulfil the requirements for a protection means in accordance with EN 81-20:2020, section 5.6.7.
- 2.3 The installer must prepare test instructions in order to meet the overall concept of the elevator system, enclose these test instructions in the elevator documents and if necessary, provide important tools or measuring devices which allow easy tests (e.g., when landing doors are closed).
- 2.4 Provided that the voltage drop on the coil has occurred within the distance of 250 mm as indicated in the scope of application it can be assumed that the requirements for braking distance and acceleration according to EN 81-20:2020, point 5.6.7.5 and 5.6.7.6 are met.
- 2.5 The Blain UCM-valve is an electrically operated check valve which can only be used in connection with an elevator valve as an additional safety valve for the prevention of unintended downward travel while a landing door is open according to EN 81-20:2020, section 5.6.7. The detection of emergency cases, the function of the brake in an upwards direction and the triggering of both brakes is the task of the control unit.
- 2.6 In order for it to function properly, the magnet of the Blain UCM-valve must be de-energized in accordance with the requirements of EN 81-20:2020, Section 5.6.6.5 at the latest when the car has moved a maximum of 250 mm from the flush position with the door open. Dead times of the electronic system must be considered.
- 2.7 The installer must be provided with written confirmation of the compliance of the component with the type tested part as well as of the guaranteed braking distances and accelerations.
- 2.8 The type examination certificate may only be used in combination with the corresponding annex and enclosure (List of authorized manufacturer of the serial production). The enclosure will be updated immediately after any change by the certification holder.

**Annex to the Type Examination Certificate
No. UK-UCM 007/2 of 2022-11-07**



3 Remarks

3.1 This type examination certificate was issued according to the following standards:

- EN 81-20:2020
- EN 81-50:2020

A revision of this type-examination certificate is inevitable in case of changes or additions of the above-mentioned standards or of changes of state of the art.

3.2 In case that there is a risk of unintended car movement in the upward direction, appropriate measures must be taken by the installer.

**Enclosure to the Type Examination Certificate
No. UK-UCM 007/2 of 2022-11-07**



Authorised Manufacturer of Serial Production – Production Sites (valid from: 2022-10-12):

Company Blain Hydraulics GmbH
Address Pfaffenstraße 1
74078 Heilbronn - Germany

- END OF DOCUMENT -

Nr.	Benennung	Zeichnungsnummer	Material	Artikelnummer	Stk.
1	Gehäuse L10 Z" F mit KS	L 113 KS	ACU/AlPb	500822	1
2	Kobenschraube	Drosselschraube Kobenschraube		101986	1
3	Notstopp M14x1,5	Notstopp M14x1,5		102078	1
4	Magnetsch AB	Magnetsch AB		102042	1
5	Typenschild mit CE 0038	EV 146 CE 0038	Aluminium mit Köber 3M 468	105716	1
6	L 10 Filter für 1,5"-2,5" L20	L 10 Filter für 1,5"-2,5" L20		500955	1
7	Verschleißschraube G2"	Schraube 16 lmg	1 0718 (11SM/PS30)	102301	3
8	Überdruckventil Flansen Schraube 18 lmg	Schrauben KV1 (B) -140		102297	1
9	KV1 0,5 Sanikoben (M4/9)	EV 256	1 0718 (11SM/PS30)	102292	1
10	Verschleißschraube G1/2"	EV 134 - 2,2	X1ZCHN186 Nr. 1.4305	102478	1
11	Sitzschraube 2,2	F 85	EN 10270-1 SH	100152	1
12	Feder	L 10 Kolben Z"		103449	1
13	L 10 Kolben Z"	EV 135	1 0718 (11SM/PS30)	102482	1
14	Magnethelm	EV 133-1	Dreingewebe	102471	1
15	Seib Magnetschalter "ab"	O-Ring 26x2 NBR 70	NBR	100226	1
16	O-Ring 26x2 NBR 70	Magnetschalter "ab"	1.4305 (8CG/NIS16-9)	102921	1
17	Magnetschalter "ab"	L 123	ACU/AlPb	103413	1
18	Deckel L10 Z"	DIN912 M10x25 schwarzverzinkt	schwarzverzinkt	100074	4
19	Winkelverschraubung	DIN912 M10x25 schwarzverzinkt	schwarzverzinkt	103038	1
20	Gewindestiftschraube 1/2"	Cera Art-Nr.: 40196	LD-PE	100166	1
21	Gewindestiftschraube 2"	EV 133	3 1645 (EN-AM-2007)	103035	2
22	Magnetschalter	F 73	EN 10270-1 SH	100160	1
23	O-Ring 58x3 NBR 70	EV 133	NBR	100253	1
24	Gewindestiftschraube 2"	O-Ring 58x3 NBR	schwarzverzinkt	500866	1
25	Gewindestiftschraube 2"	DIN913 M10x10 schwarzverzinkt	DIN 912 - Mkt14	103426	1
26	Kugelschraube	L 145	Aluminium mit Köber 3M 468	102543	1
27	Notstoppschraube	EV 148 N	Kugelmateriell, Güteklasse 3	100189	1
28	Notstopp	DIN5401-4	EN 10270-1 SH	100157	1
29	Stahnkugel	F 89	Feder	100166	1
30	Feder	F 80	Kugelmateriell, Güteklasse 3	100190	1
31	Stahnkugel	DIN5401-4			

Alternative Bauteile zu Position 31 (Füllergaugruppe):

Nr.	Benennung	Zeichnungsnummer	Material	Artikelnummer	Stk.
31 a	Gehäuse Einbaueinheit für 1,5"-2,5" L20	L 168	11SM/PS30-C	500654	1
31 b	Gehäuse Einbaueinheit für 1,5"-2,5" L20 - 6kn	L 168	11SM/PS30-C	500657	1
31 c	Gewebe Einbaueinheit für 1,5"-2,5" L20	L 197	1.4301 Dreingewebe	500651	1
31 d	Gewebe Einbaueinheit für 1,5"-2,5" L20 - 6kn	L 168	1.4301 Dreingewebe	500658	1



06. OKT. 2022
GEPRÜFT / APPROVED
 TÜV SÜD Industrie Service GmbH
 Prüfaboratorium für Produkte der Funktion
 Westendstraße 169
 80699 München
 Sachverständigenamt

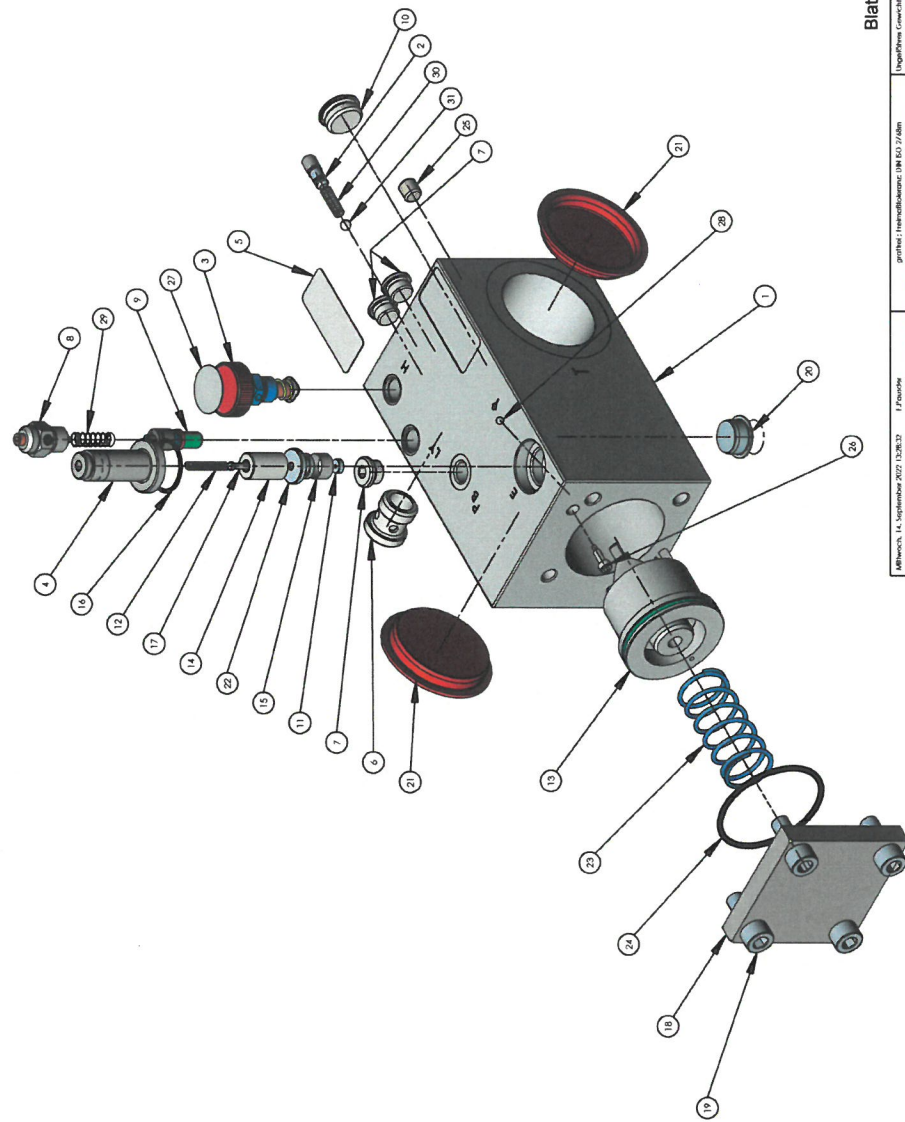
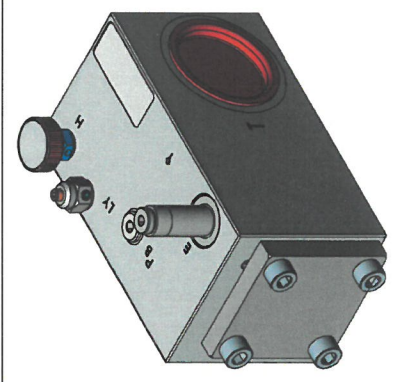

Master Typenschild (Art.Nr.29)

Art-Nr.: 103439	Benennung: Drucksperventil 2,0" mit KS	Zeichnungs-Nr.: L10 2,0" F KS b
Material: 1:2	Verstärkung: C/D	Druck: 20,07.2022
Hersteller: Röhre	Material: C/D	Druck: 20,07.2022
Hersteller: Röhre	Material: C/D	Druck: 20,07.2022

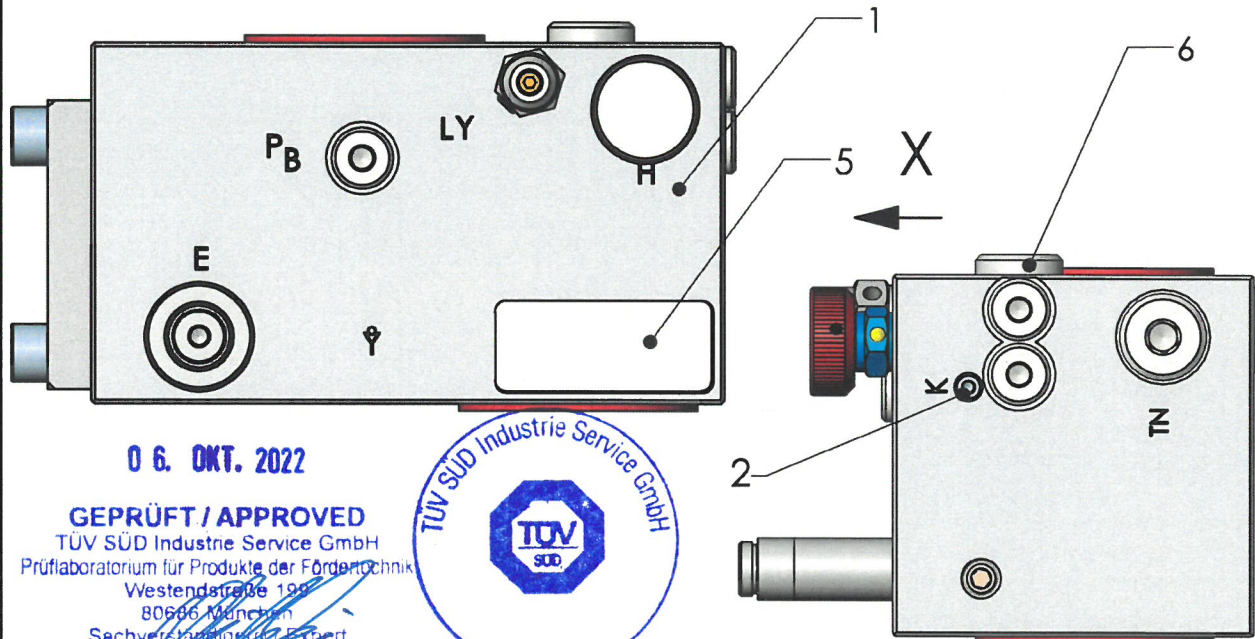
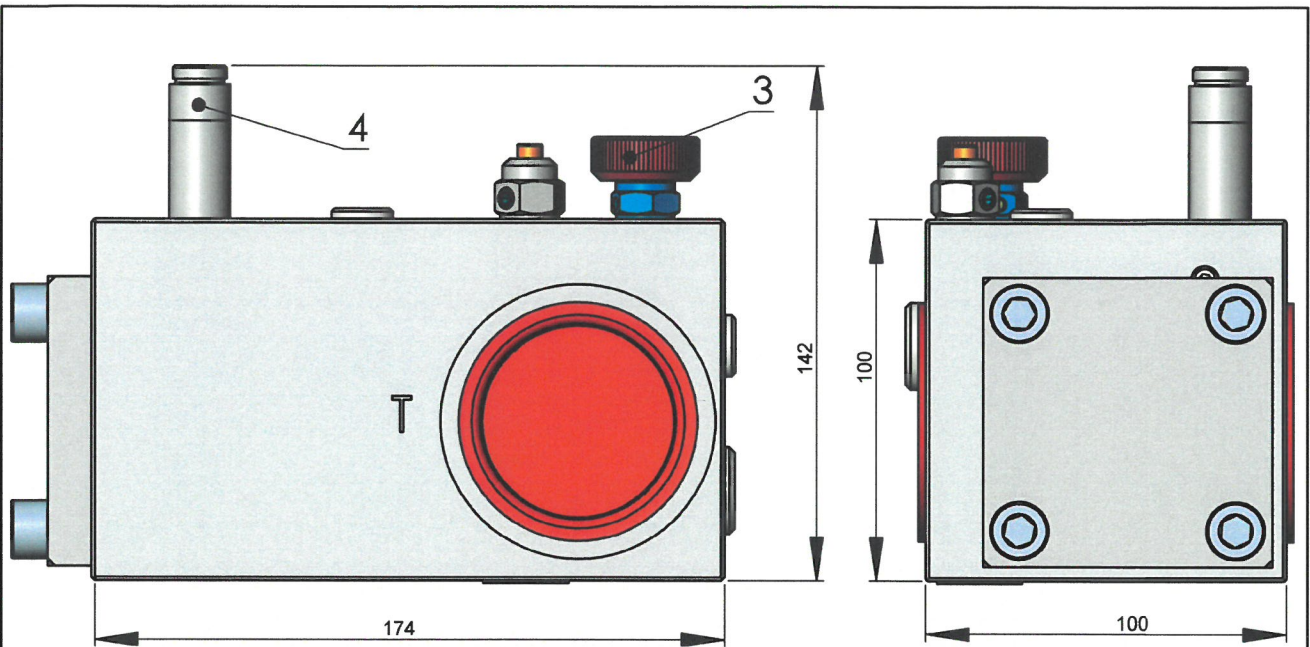

0 6. OKT. 2022

GEPRÜFT / APPROVED
 TÜV SÜD Industrie Service GmbH
 Prüflaboratorium für Produkte der Fördertechnik
 Westendstraße 199
 80606 München
 Sachverständiger/Experte

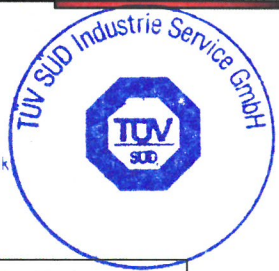

Position	Benennung
1	Gehäuse L10F 2" mit KS
2	Kolbensicherung
3	Notablaßknopf
4	Magnetrohr
5	Typenschild mit CE (EV-L10)
6	Filter

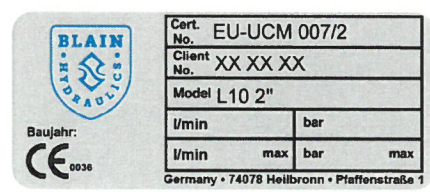

Muster Typenschild (Art.Nr.5)

Mittwoch, 14. September 2022 13:28:32		F.Pausder		graffrei ; Freimaßtoleranz: DIN ISO 2768m			Ungefähres Gewicht in Gramm :	
	Werkstoff:	Datum	Name	Maßstab	Benennung:	Art.-Nr.:	103439	
	Rohmaße:	gez 20.07.2022	CQ	1:2	Drucksperrventil 2.0" mit KS	Zeichnungs-Nr.:	L10 2.0" F KS b	

C:\Blain\L10\TUV