

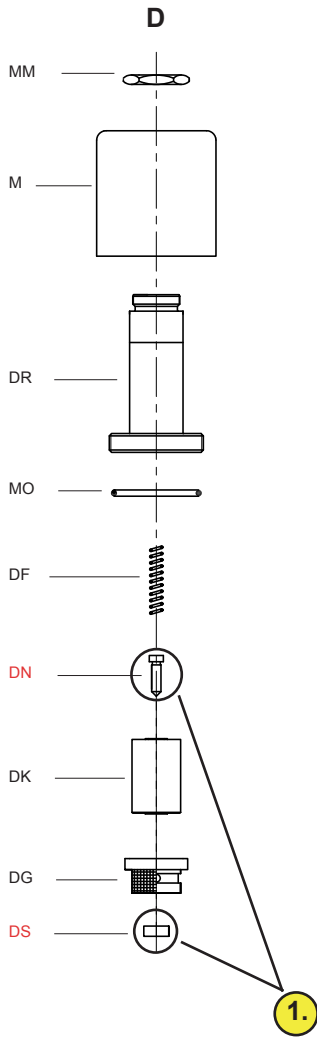

Solenoid Valves



O-Ring-Size			
No.	3/4"	1 1/2"	2 1/2"
FO	26x2P	47x2.5P	58x3P *
EO	9x2P	9x2P	9x2P
UO	26x2V	39.34x2.62V	58x3V
WO	5.28x1.78V	5.28x1.78V	5.28x1.78V
VO	23x2.5V	42x3V	60x3V **
7O	5.28x1.78P	9x2P	9x2P
XO	13x2V	30x3V	47x3V
HO	5.28x1.78V	5.28x1.78V	5.28x1.78V
SO	5.28x1.78P	5.28x1.78P	5.28x1.78P
MO	26x2P	26x2P	26x2P

\* FO by 4F 2 1/2" is 67x2.5P  
 \*\* 90 Shore  
 O-Ring: V=FKM-Viton  
 P=NBR-Perbunan

Adjustments

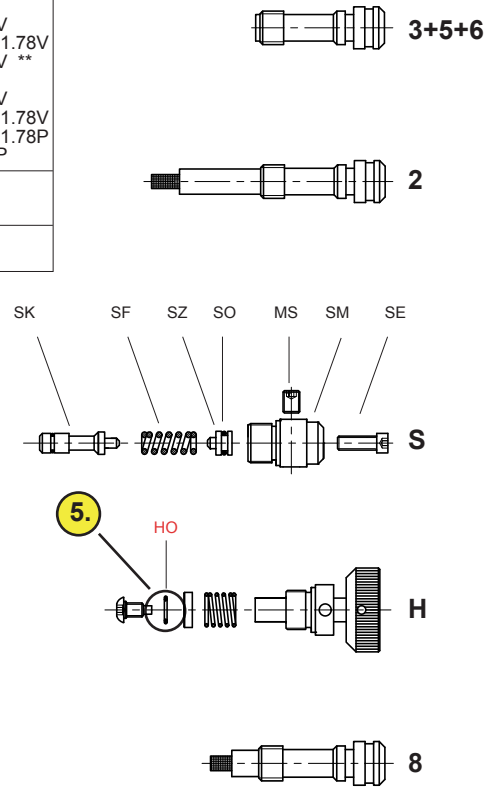

Replace possible leaking parts (DS & DN, XO, VO & WO, FO and HO) in the order of probabilities 1 - 5.  
 Replace part 1 and check if the valve is leakproof now.  
 Replace part 2 only if the valve is still leaking, etc.

Flow Valves

